

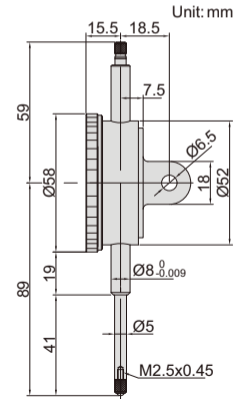

**2889-30**

- With limit pointers
- Optional accessory: backs, contact points



Code	Range	Graduation	Accuracy	Hysteresis	Range/rev	Dial reading	Remark
<b>2889-30 *</b>	30mm	0.01mm	35µm	7µm	1mm	0-100	lug back
<b>2889-30F *</b>	30mm	0.01mm	35µm	7µm	1mm	0-100	flat back

\* Supplied with manufacturer inspection certificate